

**POST INDICATOR**

**Wall Type Post Indicator / Model A-WPI**



Wall indicator post provides a means to operate a valve installed behind a wall and able to indicate the open or shut position of the valve.

**NOTE:** Ensure that the non-rising stem gate valve is in the fully open position before installing the Wall Post Indicator.

For use with 4" to 12" NRS indicating post gate valve

**Weight:** 40,8kg.(90lbs.)

**Field Adjustment:**

- 1- Remove the Top Section from the top of the Indicator Post assembly;
- 2- Cut the required stem length
- 3- Set the "OPEN" and "SHUT" targets for the appropriate valve size;
- 4- Reattach the Top Section to the top of the Indicator Post assembly.

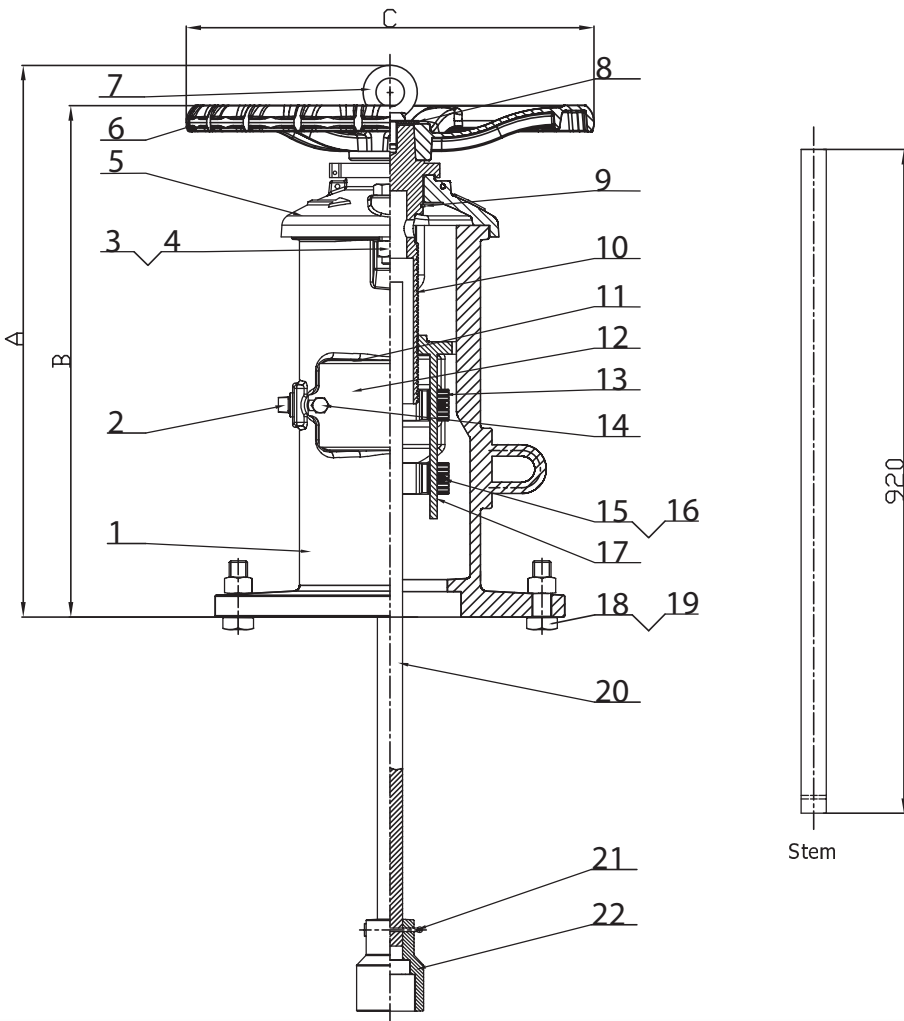

DIMENSIONS (mm)		
A	B	C
497	447	356



# POST INDICATOR

## Material List

No	Part	Material	ASTM Specification
1	Body	Cast Iron	ASTM A126 Class B
2	Plug	Malleable Iron-Galvanised	
3	Square Nut	Carbon Steel Zinch Plated	
4	Hex Bolt	Carbon Steel Zinch Plated	
5	Cover	Cast Iron	EN-GJL-200
6	Hand Wheel	Ductile Iron	ASTM A536 65-45-12
7	Eye Bolt	Carbon Steel Zinch Plated	
8	Gasket	Carbon Steel Zinch Plated	
9	Snap Ring	Spring Steel	
10	Operating Nut	Stainless Steel	AISI 304
11	Gasket	EPDM	

No	Part	Material	ASTM Specification
12	Window Class	Plexiglass	
13	Target	Cast Aluminium	
14	Hex Bolt	Carbon Steel Zinch Plated	
15	Hex Bolt	Carbon Steel Zinch Plated	
16	Hex Nut	Carbon Steel Zinch Plated	
17	Target Carrier Nut	Stainless Steel	AISI 304
18	Hex Nut	Carbon Steel Zinch Plated	
19	Hex Bolt	Carbon Steel Zinch Plated	
20	Stem 1" Square	Carbon Steel	
21	Cotter Pin	Stainless Steel	AISI 304
22	Socket	Cast Iron	ASTM A536 65-45-12

## Typical Installation

